

Employer of the Day Table Location

When you arrive, please check in at the Center for Career Development and Community-Based Learning in the College Center building on the second floor. We are located across from Counseling and Advising. One of our employees will walk you to your spot in which you set up. There is a chance that no one will be here at that time. If that is the case, please consult the map/directions included at the bottom of this email or go directly to the Employer table.

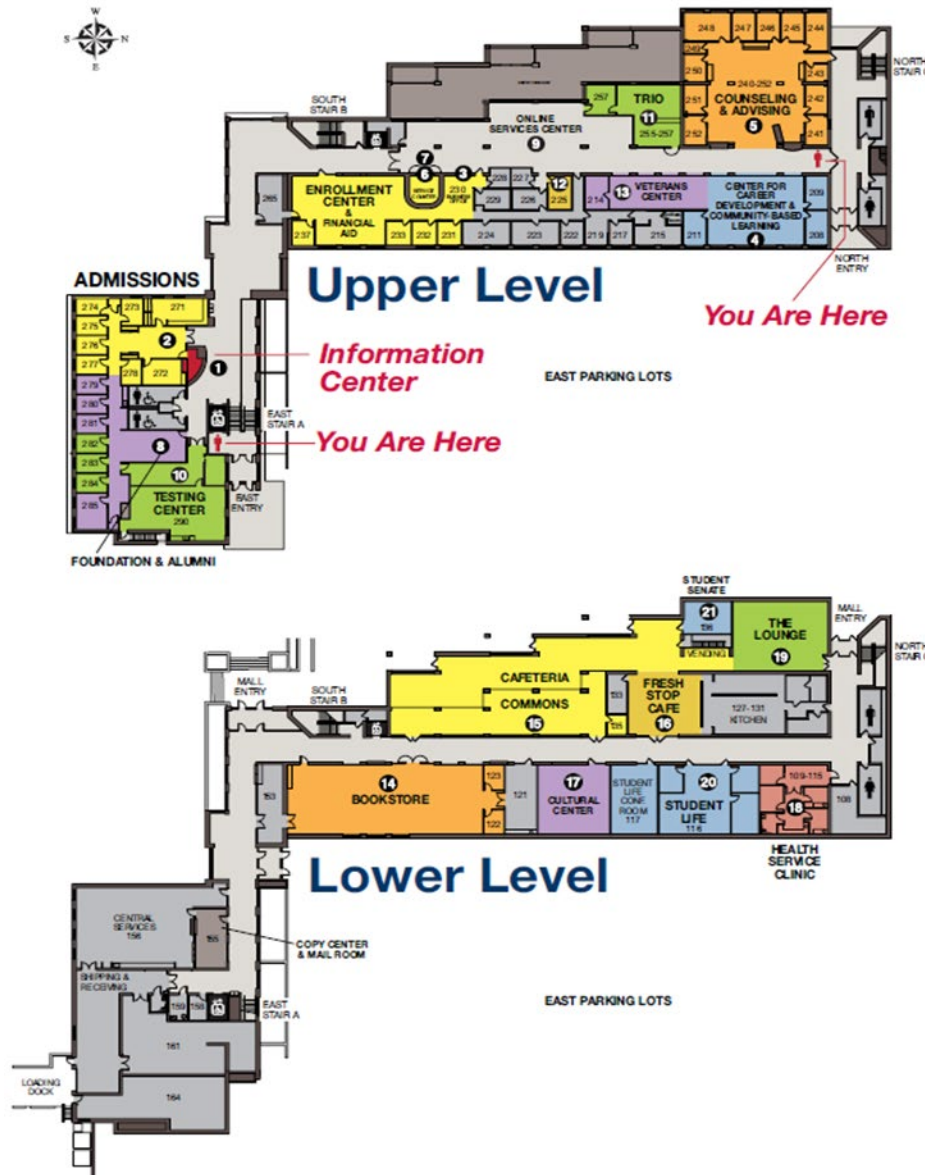

Inver Hills
Community College

College Center

Upper Level

- 1** Information Center
- 2** Admissions CC270
- 3** Business Office CC230
- 4** Career Development
- 5** Counseling & Advising
- 6** Enrollment Center
- 7** Financial Aid
- 8** Foundation & Alumni
- 9** Online Services Center
- 10** Testing Center CC290
- 11** TRIO
- 12** TuitionMatch-MN CC225
- 13** Veterans Center

Lower Level

- 14** Bookstore
- 15** Cafeteria / Commons
- 16** Fresh Stop Cafe
- 17** Cultural Center
- 18** Health Service Clinic
- 19** Lounge
- 20** Student Life
- 21** Student Senate CC136
- E** Elevators
- R** Restrooms

This is the Employer of the Day table situated outside of the Lounge. This picture is taken from the North Stairwell.



You know you are at the right table when you see this sign!!

