

Connecting with a Computer

These steps apply to individuals using Zoom on a computer including Windows, Mac Os, and Linux.



Win



Mac Os



Linux

1: Select **Sign in**

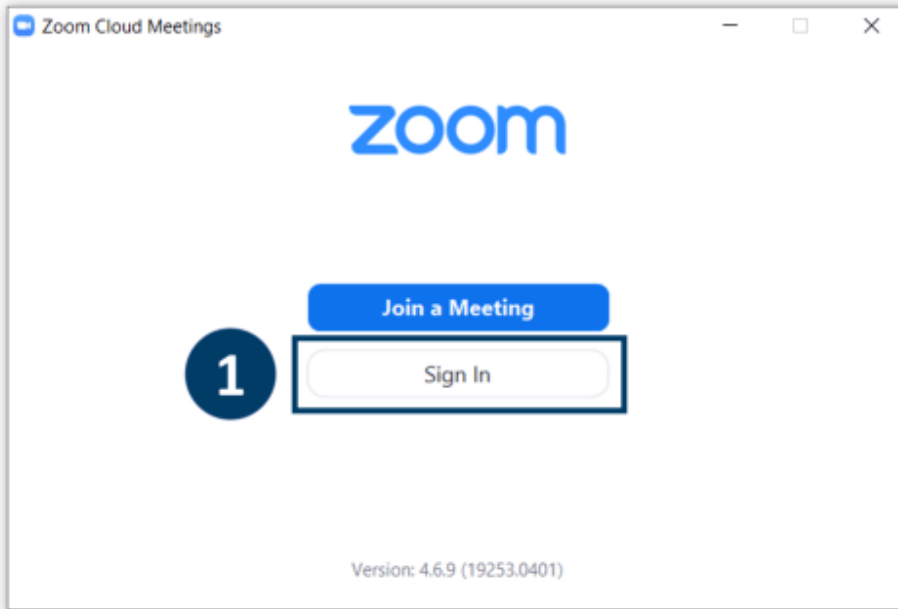

Screenshot of Zoom

application with the option to sign in outlined

2: Select **Sign in with SSO**

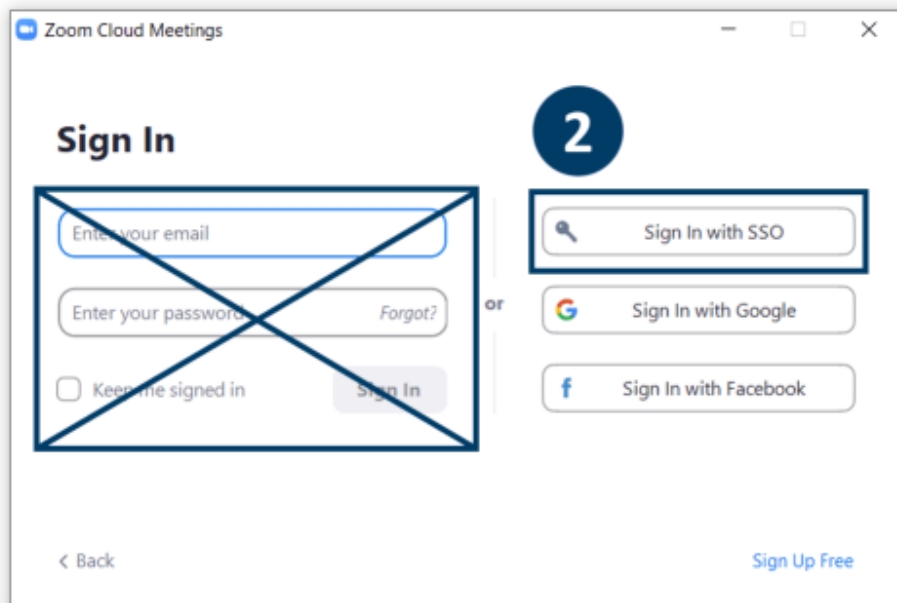

3: Enter minnstate

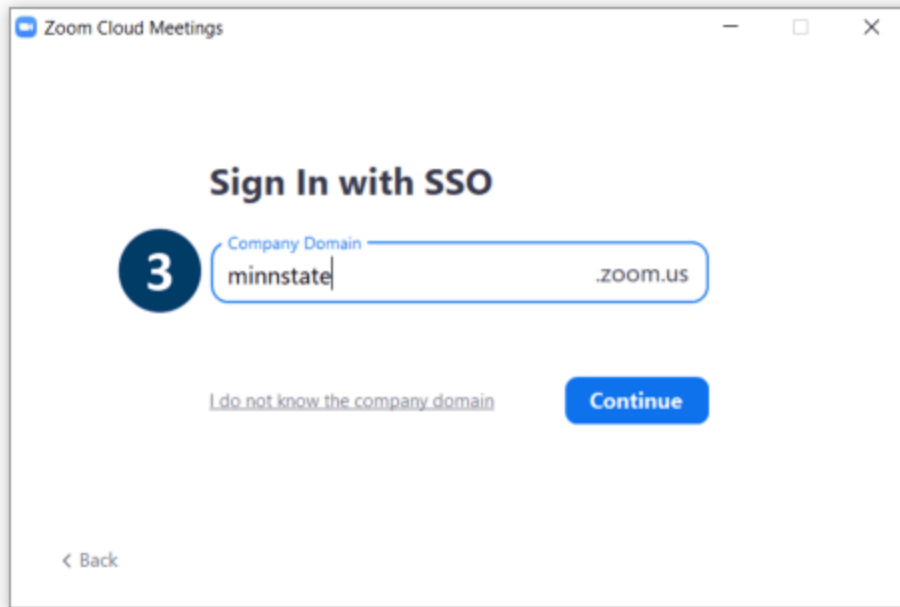

4: Enter your StarID and Password



5: Confirm you have Signed In in the Zoom app

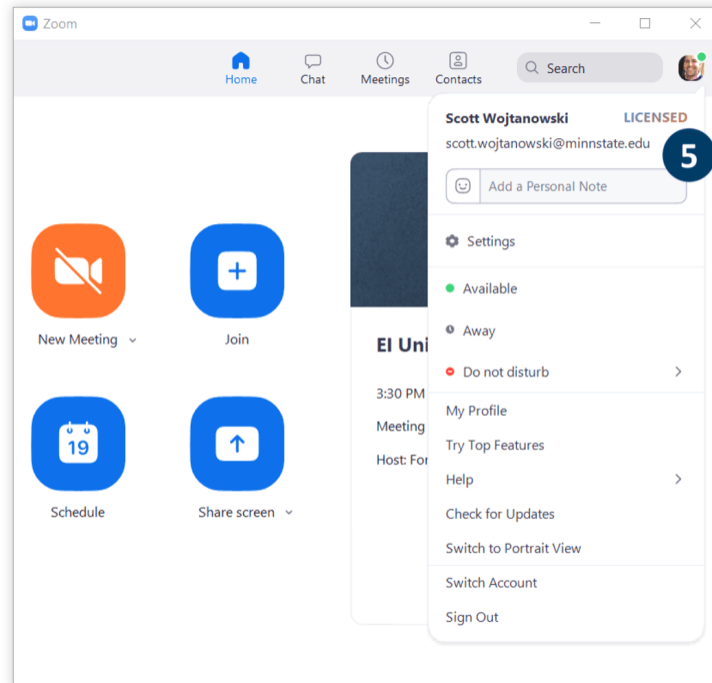

[back to the top](#)

Connecting with a mobile device

These steps apply to the individuals using Zoom on mobile devices including Apple iOS and Android devices.



Apple iOS



Android

1: Select **Sign in**



2: Select **Sign in with SSO**

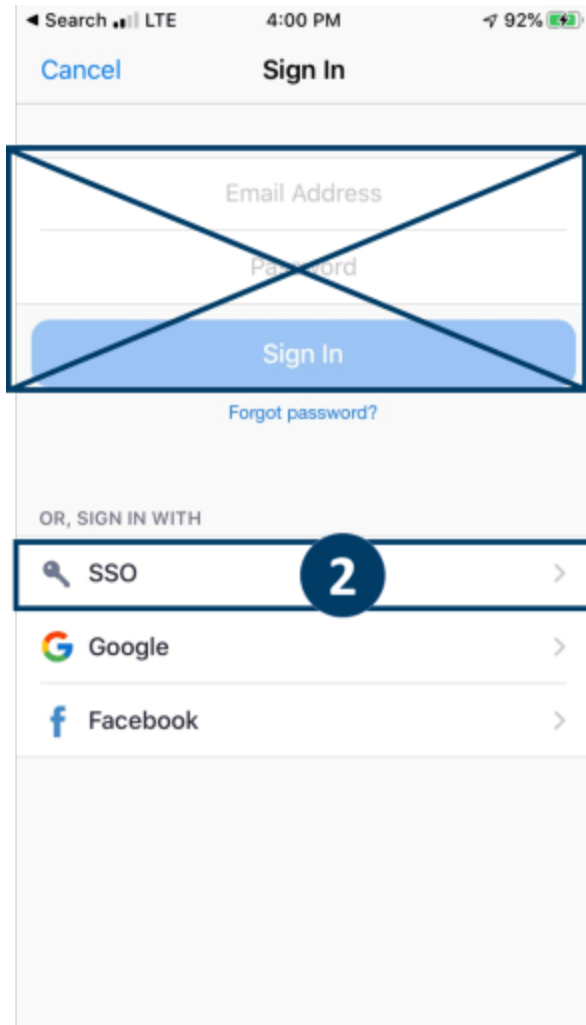

3: Enter minnstate

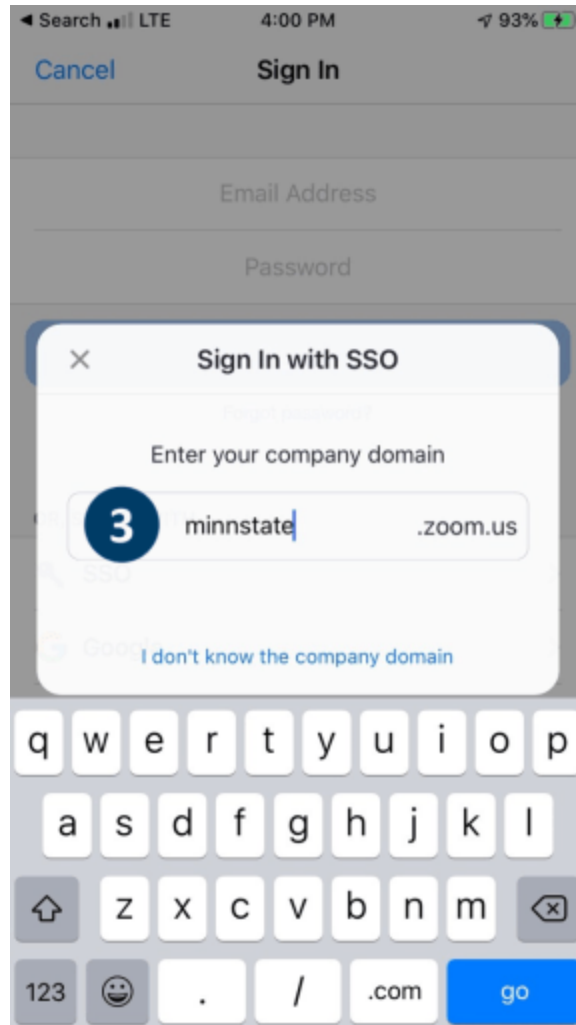

4: Enter your StarID and Password

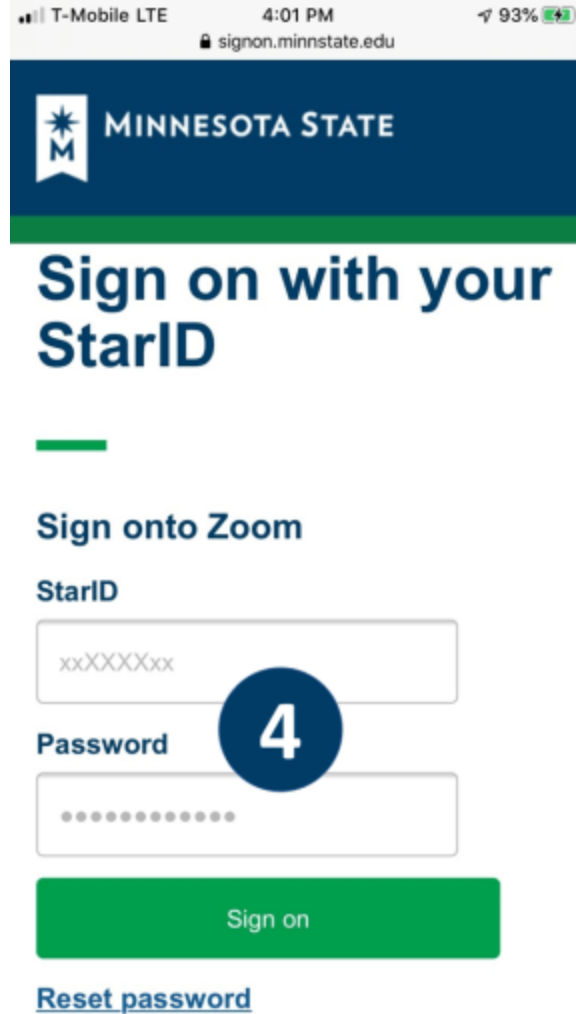

5: Confirm you have Signed In in the Zoom mobile app

Settings



Scott Wojtanowski LICENSED

5

scott.wojtanowski@minnstate.edu

Meetings

Contacts

Chat

General

Siri Shortcuts

About

Copyright ©2012-2020 Zoom Video Communications, Inc.
All rights reserved

